



RAVENHURST COURT

RISLEY
WARRINGTON



INDUSTRIAL / WAREHOUSE UNIT **FIVE**

3,033 SQ FT

(282 SQ M)

INDUSTRIAL / WAREHOUSE

UNIT FIVE

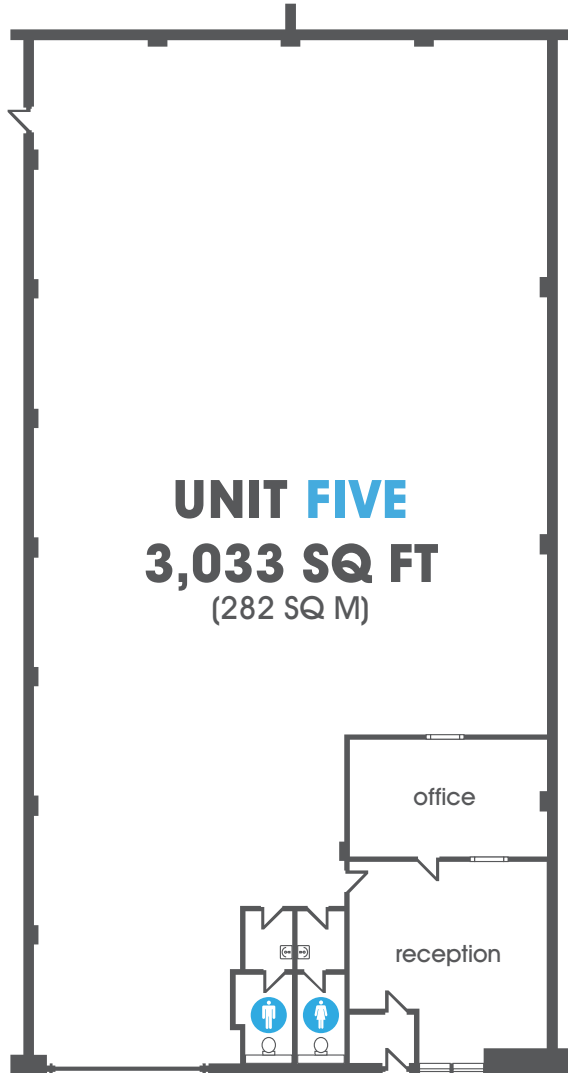

SPECIFICATION

- Steel portal frame construction
- 6 m eaves height
- Full height steel cladding
- Metal clad insulated roof incorporating roof lights
- Concrete floor
- Fully fitted office accommodation plus w/c facilities in each unit
- Full height roller shutter doors
- Staff / customer dedicated parking
- All mains services available



Orbit
Developments

0151 523 8790
www.orbit-developments.co.uk

Colliers
0161 831 3300
www.colliers.com/uk/industrial

Roberts
Vain Wilshaw
0161 401 5060
www.robertsvainwilshaw.co.uk

DISCLAIMER: These Particulars are believed to be correct at time of going to Press, but the Developer reserves the right to change the scheme in the future. However, the Vendors / Lessors and Agents of this property give notice that: (1) These Particulars are intended as a general outline only, for the guidance of prospective purchasers or tenants, and do not constitute the whole or any part of an offer or contract. (2) They cannot guarantee the accuracy of any description, dimension or other details contained in these Particulars and prospective purchasers or tenants should not rely on them as statements of fact or representation, but must satisfy themselves as to the accuracy of such details. (3) No employee of the Agents has any authority to make or give any representation or warranty, or enter into any contract whatsoever in relation to the property. (0813)